



Activity 2 - Build a Bird House

Adult supervision required. For ages 14 and up!

Instructions: Gather the materials and tools, then follow steps 1 through 6.

Materials List:

26" of $\frac{3}{4}$ " Pine
 1-1/2" Wood Screws (21)
 1/2" Wood Screws (6)
 Hinge

Tools:

Philips Screwdriver
 Hand Saw
 Hand Drill
 3/16" Drill Bit
 2" Wood-Boring Drill Bit

1. Drill and Cut the following wood pieces.

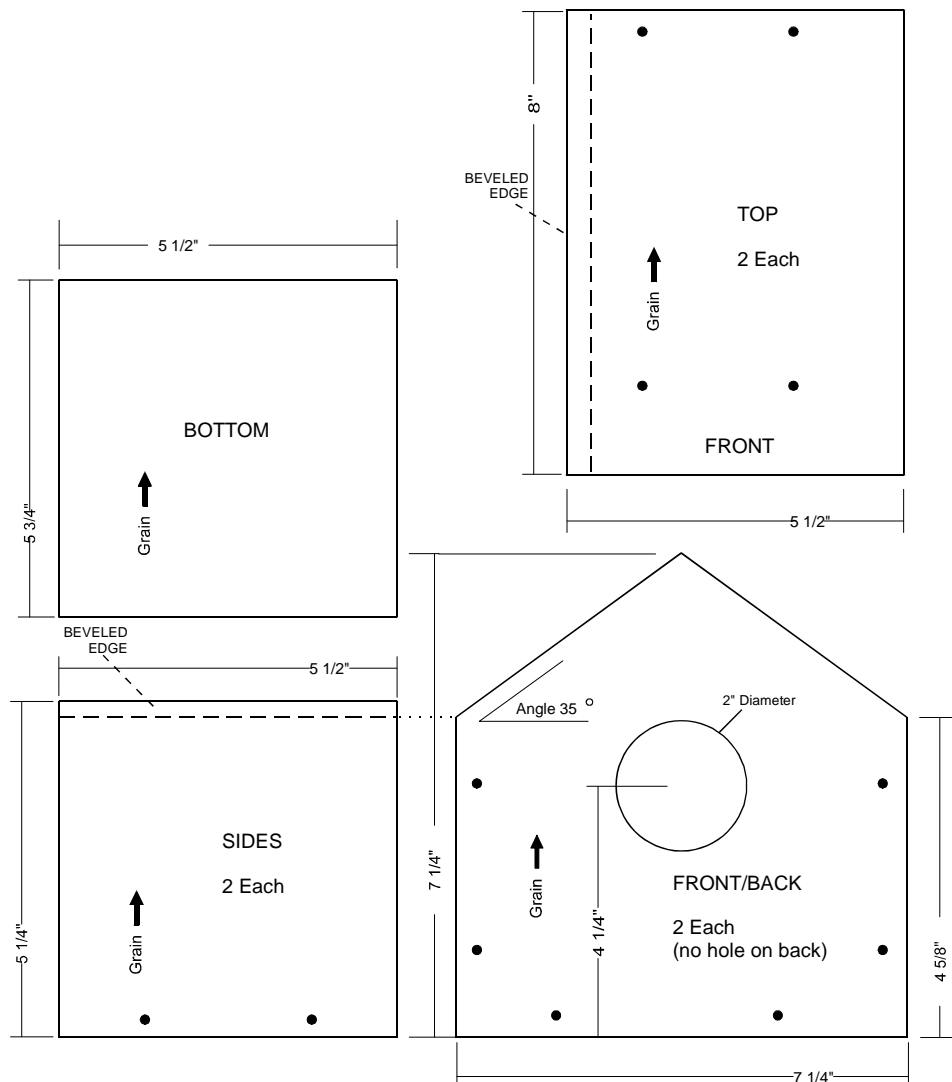

2. Attach the 2 sides to the bottom of the house with 2 screws each through the pre-drilled holes on the lower edge of the sides. The ends of the sides and bottom should be flush with each other when attached. The beveled edges of the side are at the top and touch the roof.
3. Attach the front and back of the house to the sides and bottom (already attached in step 1 above) with screws through the 6 holes provided.
4. Attach one half of the roof to the front and back walls. Be sure that the roof is flush with the back of the house and overhangs the front and that the beveled edge is vertical at the front and back peaks. There will be overhang at the sides.
5. The remaining half of the roof can now be attached to the first half with a hinge and secured with a single screw to the top-center of the wall.
6. Hang the house from a tree branch or the roof eve of a garage.

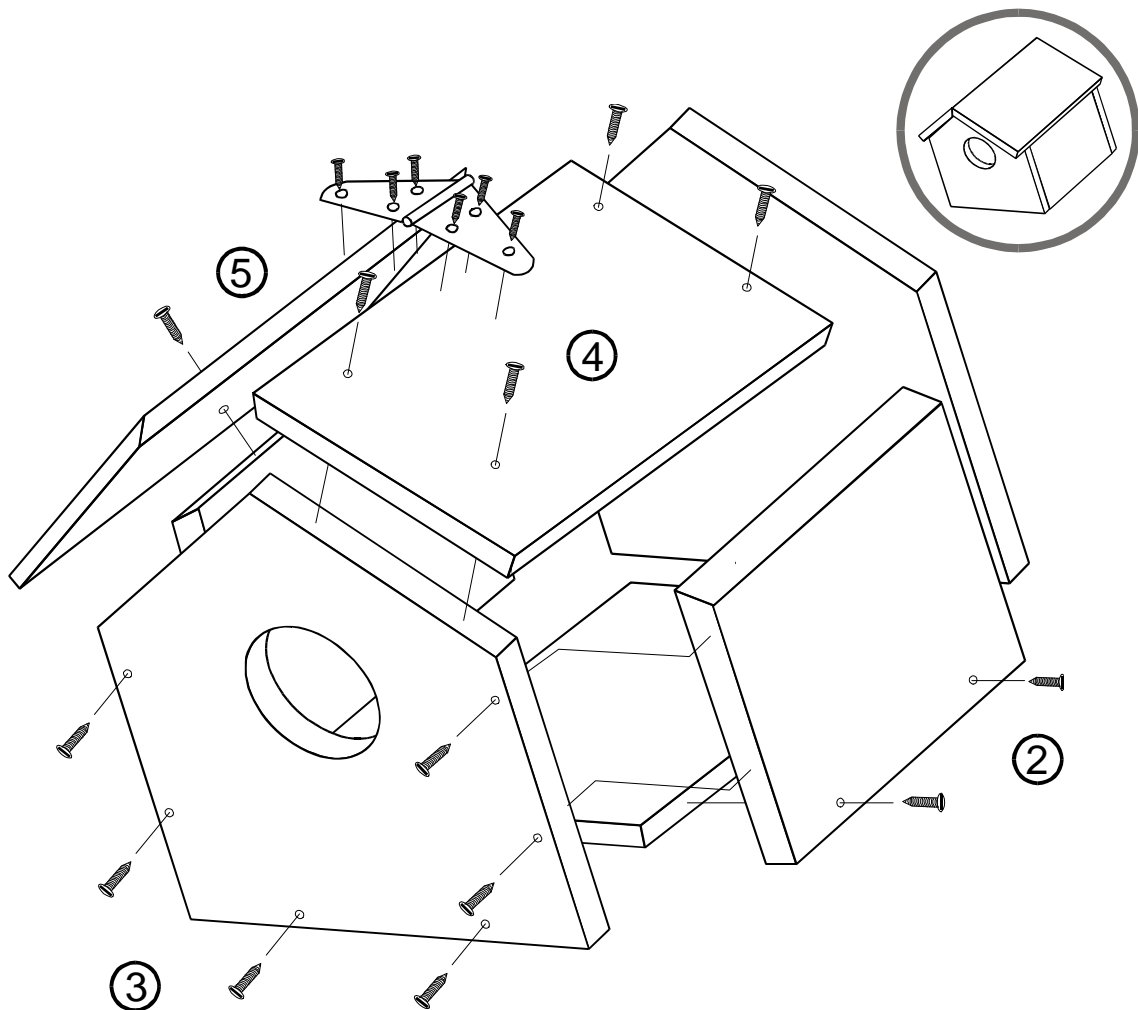

Assembly View

